

**L.O.G. HEIGL**  
FERGUSON ERSATZTEILE

# PRODUCT NEWS

CONTACT US TO PLACE YOUR ORDER

t. 094 223 123 e. [info@ferguson-shop.eu](mailto:info@ferguson-shop.eu)

[ferguson-shop.eu](http://ferguson-shop.eu)

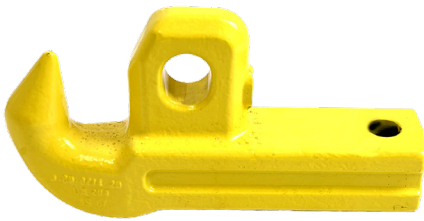

## PICK UP HITCH HOOK

400591 | OE Ref: 47961036

Case Maxxum Puma Series  
New Holland T5 T6 T7 Series



## DRAWBAR PICK UP HITCH

400592 | OE Ref: 47961032

Case Maxxum Puma Series  
New Holland T5 T6 T7 Series



**QTP** DEVELOPED

## CAB BLOWER

59637R | OE Ref: AL110881

John Deere 5E 6D 6E  
6000 7000 Industrial



## CAB FOAM KIT

62188 | OE Ref: 3900646M1

Massey Ferguson 300 Series



## FLYWHEEL

56788 | OE Ref: 02249939

Deutz Agrostar DX Intrac Series



**QTP** DEVELOPED

## SHOCK ABSORBER

56650 | OE Ref: G930500200111

Fendt Vario 400 700 800 900  
Favorit 700 900 Series

# MASSEY FERGUSON



**WHEEL HUB WITH  
BEARINGS CAPS STUDS**

886336C | OE Ref: 886337M91

Massey Ferguson 100 200  
300 35 65 700 & 800 Series



**WHEEL HUB WITH  
BEARINGS CAPS STUDS**

6288C | OE Ref: 898348M3

Massey Ferguson 100 200 300  
500 600 65 700 & 800 Series



**CROWN WHEEL & PINION SET**

67438 | OE Ref: 3426638M91

Massey Ferguson 200 300 Series



**ROOF HATCH**

600259 | OE Ref: 3787166M92

Massey Ferguson 5400 5600  
6400 7400 7600 7700 Series



**CLUTCH PEDAL TOP**

600202 | OE Ref: 1626321M2

Massey Ferguson 3000 3600  
5400 6400 7400 8200 Series

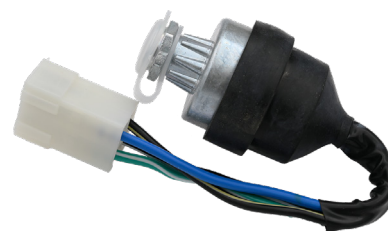

**IGNITION SWITCH**

6758R | OE Ref: 3699692M92

Massey Ferguson 300  
4200 4300 5200 5300 Series



**PTO GUARD**

600203 | OE Ref: 3801418M91

Massey Ferguson  
4200 4300 Series



**SEAL FOR AIR COMPRESSOR**

600263 | OE Ref: 4286085M2

Massey Ferguson 5400 6400  
7400 7600 8600 Series



**SPARK PLUG**

61345 | OE Ref: S42484

Massey Ferguson 20 TVO 35 4 Cylinder



**THERMOSTAT**

600260 | OE Ref: 3637649M1

Massey Ferguson 64 66 77 Series



**THERMOSTAT ASSEMBLY**

600261 | OE Ref: 4224636M91

Massey Ferguson 6200 Series



**FAN BELT WITH AIRCON**

600229 | OE Ref: 4350583M2

Massey Ferguson 5700  
6600 7600 Series



**BEACON KIT**

43592 | OE Ref: 82018390

Ford New Holland T6 T7 T6000  
Range & Power Command Series**BEACON 12/24V POLE MOUNTED**

43628 | OE Ref: 82018390

Case JX MXM Puma Maxxum  
Ford TM TS T6 T7 Series**LED HEADLIGHT**

70176LED | OE Ref: 5122379

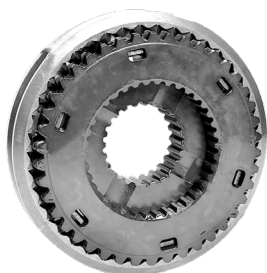
Fiat 46 56 66 90 93 94  
Classique Series**QTP DEVELOPED****SYNCHRONISER ASSEMBLY**

41648R | OE Ref: 87537028

Case Maxxum MXM Puma Series

**QTP DEVELOPED****SYNCHRONISER ASSEMBLY**

409916R | OE Ref: 82013857

New Holland 40 TS Series

**QTP DEVELOPED****SYNCHRONISER ASSEMBLY**

41725R | OE Ref: 87567127

Case MXM Puma Series

**DUST CAP**

400586 | OE Ref: 5188836

Case Maxum Puma Series  
New Holland T6 T7 T6000 Series**GREEN DUST CAP LENS**

400587 | OE Ref: 82029892

Case Maxxum Puma Series  
New Holland T6 T7 T6000 Series**BLUE DUST CAP LENS**

400588 | OE Ref: 82029893

Case Maxxum Puma Series  
New Holland T6 T7 T6000 Series**PTO CABLE**

400595 | OE Ref: 47580968

Case Puma Series  
New Holland T7 Series**RED DUST CAP LENS**

400589 | OE Ref: 82029894

Case Maxxum Puma Series  
New Holland T6 T7 T6000 Series**BLACK DUST CAP LENS**

400590 | OE Ref: 82029895

Case Maxxum Puma Series  
New Holland T6 T7 T6000 Series



## HYDRAULIC ACCUMULATOR

500624 | OE Ref: RE306377

John Deere 7020 7030 7J 7R Series



**BACK IN STOCK**

## WORK LAMP

58296B | OE Ref: AL164390

John Deere 6020 6030 Series



## LED HEADLAMP

58749LED | OE Ref: AL178138

John Deere 6030 7030 Premium Series

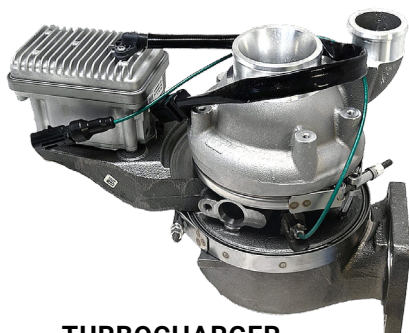

## TURBOCHARGER

500875 | OE Ref: DZ127353

John Deere 6105M-6140M  
6105R-6130R Series



## COMPLETE HEAD LAMP FRAME KIT

500854 | OE Ref: AL181532

John Deere 30 6030 7030 Series  
RH Dip European Driving



## COMPLETE HEAD LAMP FRAME KIT

500855 | OE Ref: AL181530

John Deere 30 6030 7030 Series  
LH Dip UK Driving



**QTP DEVELOPED**

## PRIMARY AIR FILTER

56964 | OE Ref: AL230505

John Deere 6M Series



**QTP DEVELOPED**

## SECONDARY AIR FILTER

56945 | OE Ref: AL225872

John Deere 6M Series



## CLUTCH RELEASE BEARING

3985R | OE Ref: AL66088

John Deere 40 50 55 Series



## AIR TEMP SENSOR ON ENGINE

580190 | OE Ref: RE525016

John Deere 9030  
6M 5M 5R 8R Series



**QTP DEVELOPED**

## UPPER RADIATOR HOSE

56838 | OE Ref: L218517

John Deere 6M 6R Series



## SOLENOID VALVE

56800 | OE Ref: AL168968

John Deere 6030 7030 6M 6R Series





## NEW DESIGN

### LIGHT BAR

56104

6,120 Lumen

Size: 42.5 x 11.3 x 9cm



## NEW DESIGN

### LIGHT BAR

56106

10,200 Lumen

Size: 63 x 11.3 x 9cm



## NEW DESIGN

### LIGHT BAR

56103

15,300 Lumen

Size 82 x 11.3 x 9cm



## BACK IN STOCK

### HAND PALLET TRUCK 3 TON

56446



### WHEEL SPINNER

500763 | OE Ref: MCXFA1566



### WHEEL SPINNER

500767 | OE Ref: MCXFA1567



### WHEEL SPINNER

500762 | OE Ref: MCXFA1564



### WHEEL SPINNER

500764 | OE Ref: MCXFA1561



### WHEEL SPINNER

500765 | OE Ref: MCXFA1562



### WHEEL SPINNER 15"

1148 | OE Ref: S626



### WHEEL SPINNER 30"

4029



### WHEEL SPINNER

1197 | OE Ref: S14922

# ELECTRICAL CONNECTORS

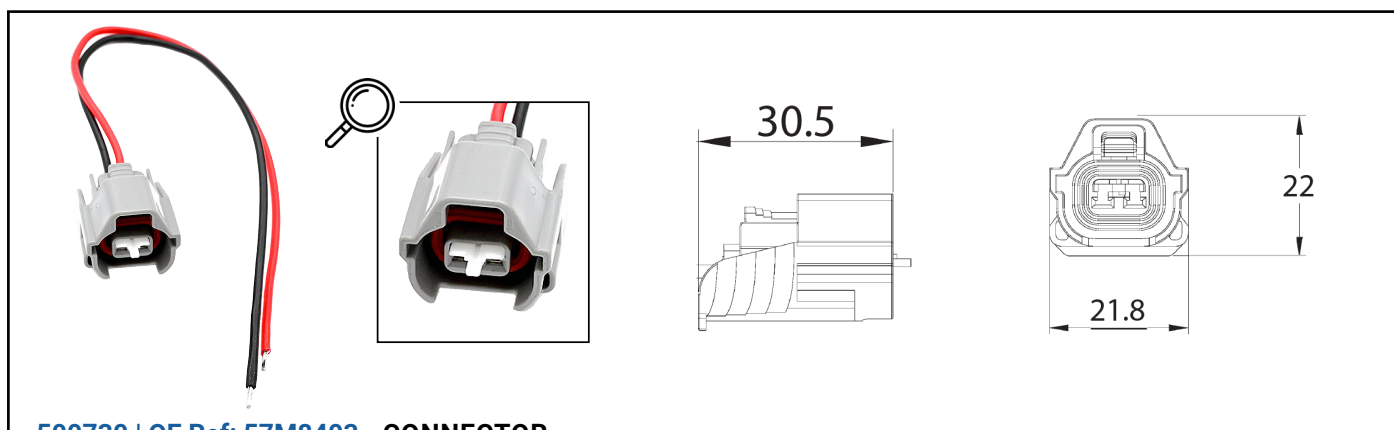

500730 | OE Ref: 57M8403 - CONNECTOR

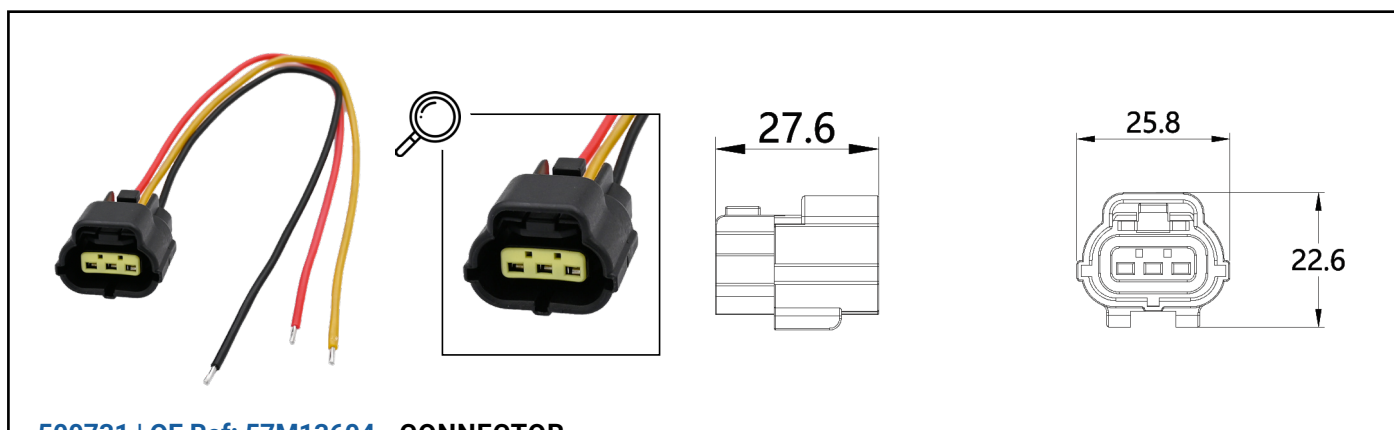

500731 | OE Ref: 57M13604 - CONNECTOR

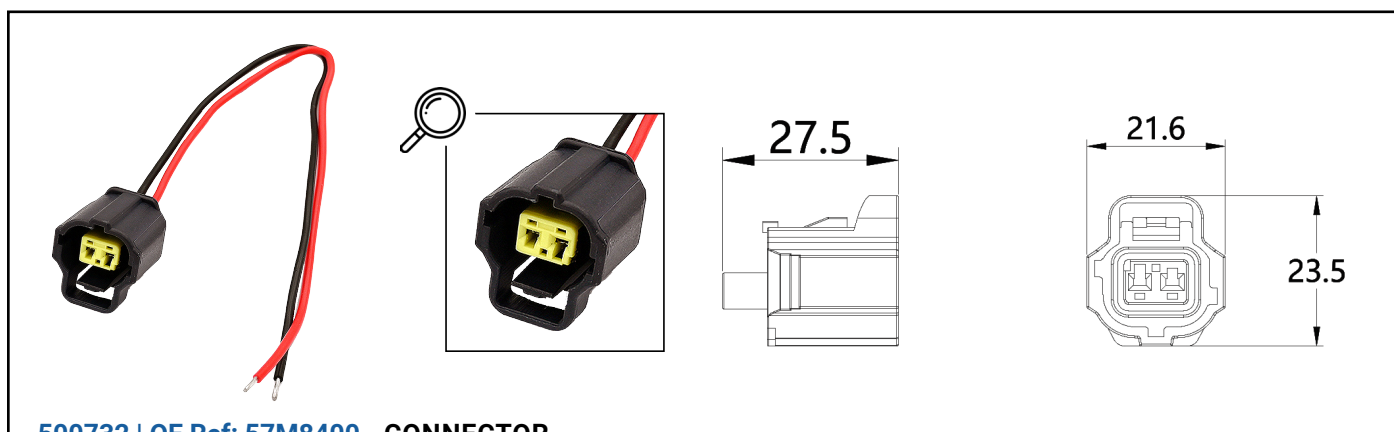

500732 | OE Ref: 57M8400 - CONNECTOR

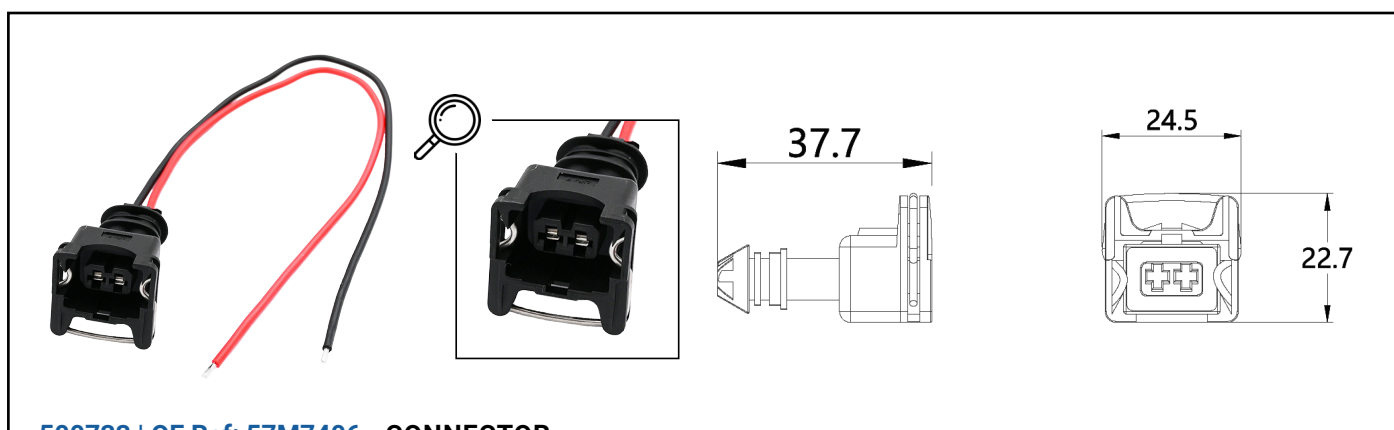

500733 | OE Ref: 57M7406 - CONNECTOR



# ELECTRICAL CONNECTORS

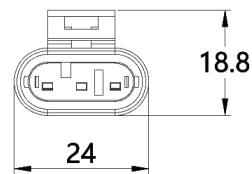
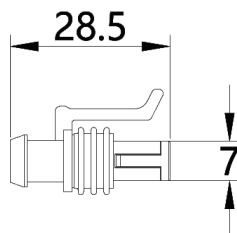

500734 | OE Ref: 57M8542 - CONNECTOR

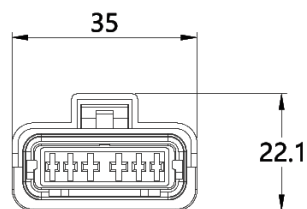
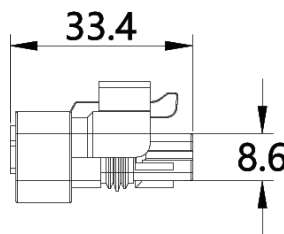
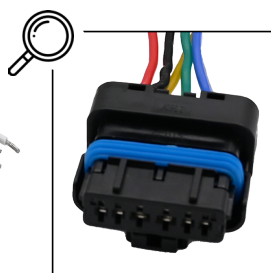
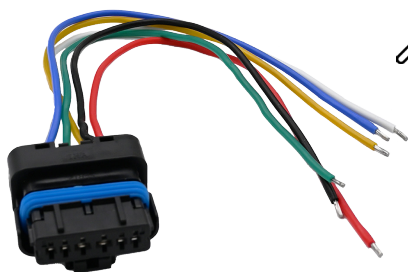

500735 | OE Ref: 57M13011 - CONNECTOR

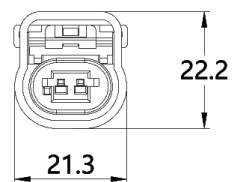
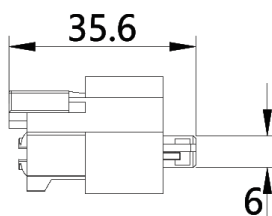
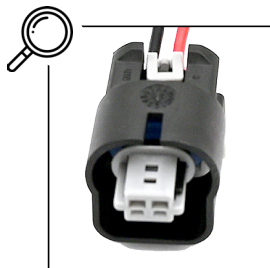
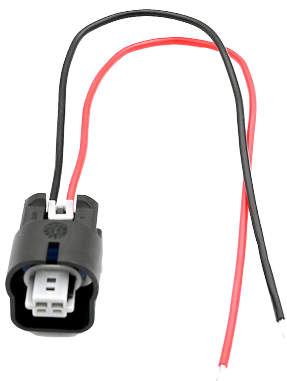

500736 | OE Ref: 57M8612 - CONNECTOR

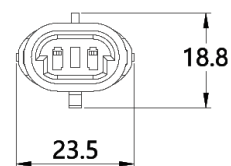
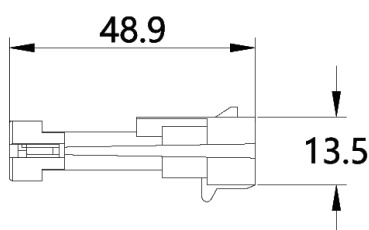
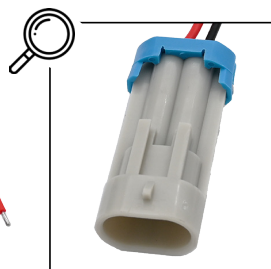
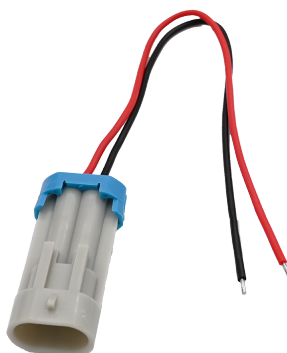

500737 | OE Ref: 57M8408 - CONNECTOR

# ELECTRICAL CONNECTORS

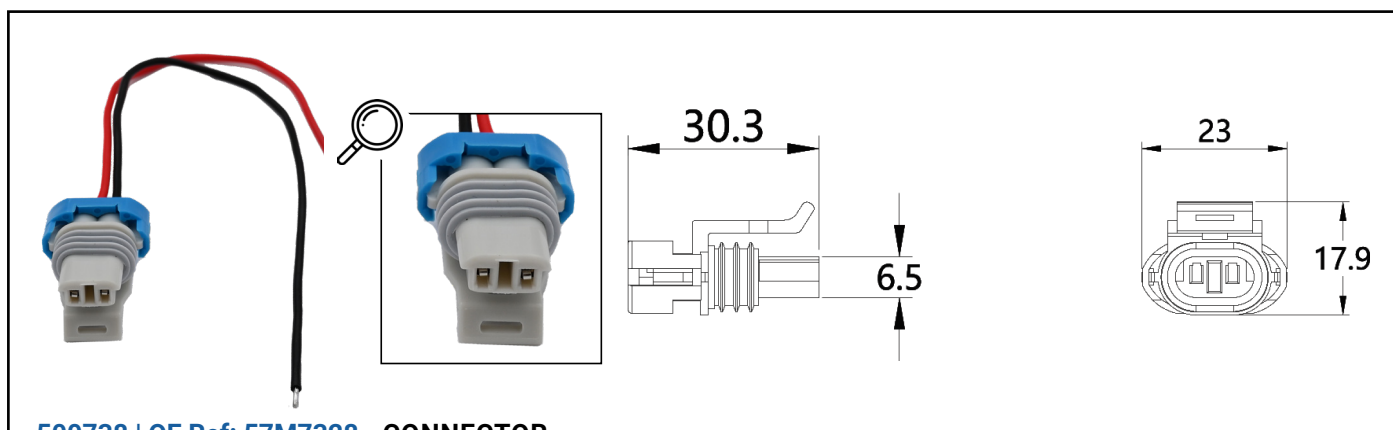

500738 | OE Ref: 57M7328 - CONNECTOR

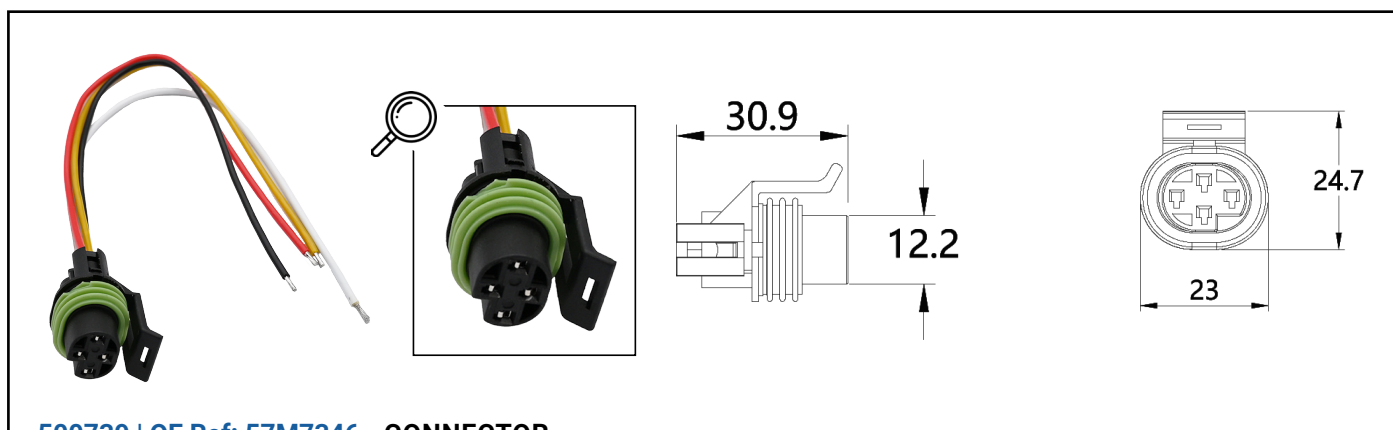

500739 | OE Ref: 57M7346 - CONNECTOR

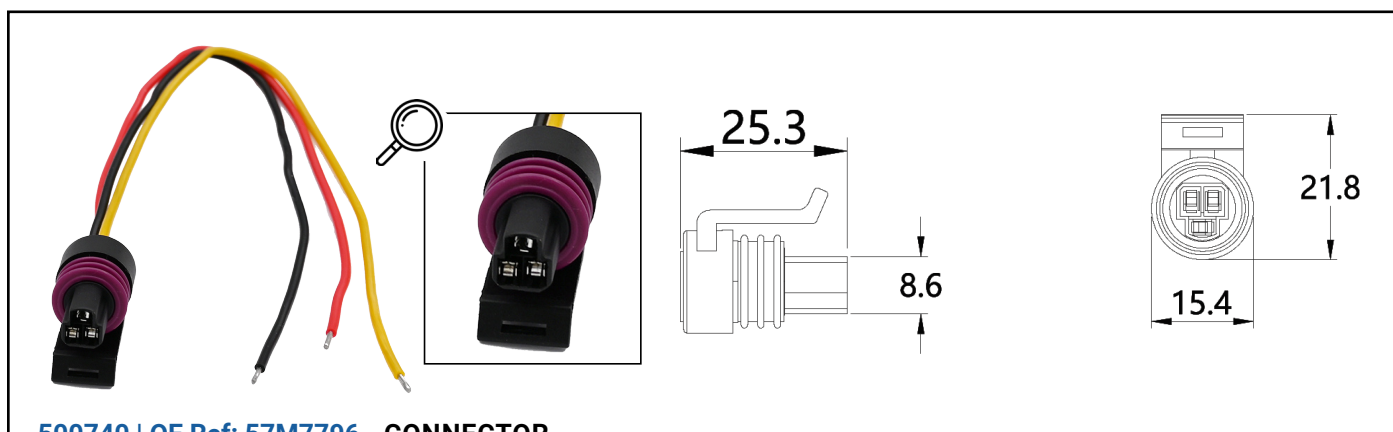

500740 | OE Ref: 57M7796 - CONNECTOR

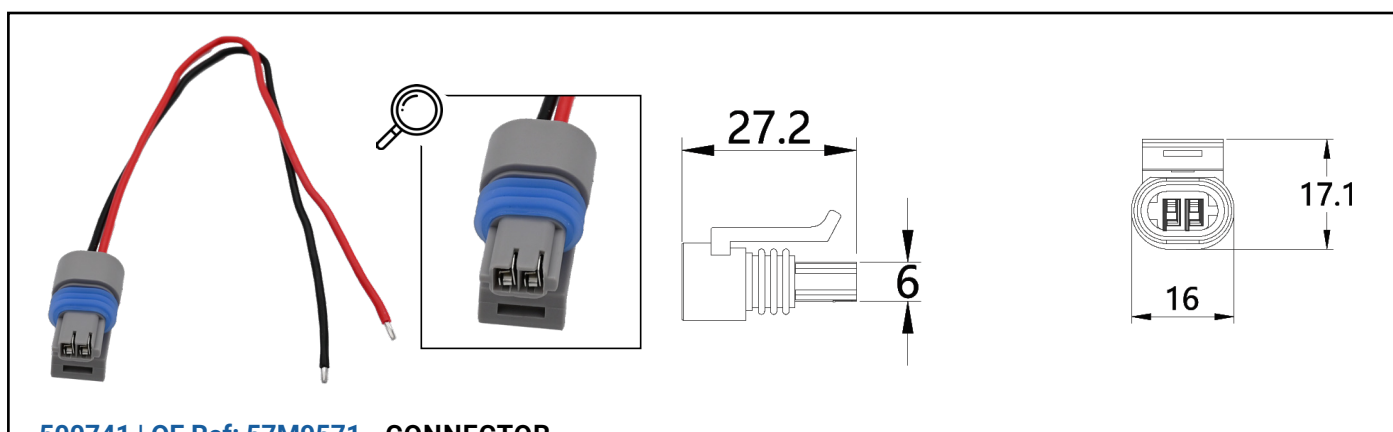

500741 | OE Ref: 57M9571 - CONNECTOR



# ELECTRICAL CONNECTORS

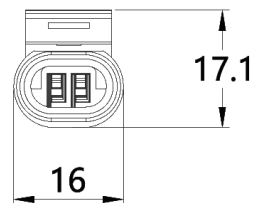
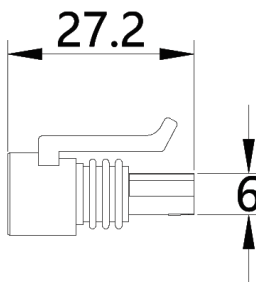

500742 | OE Ref: 57M7379 - CONNECTOR

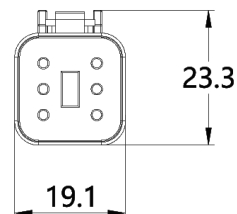
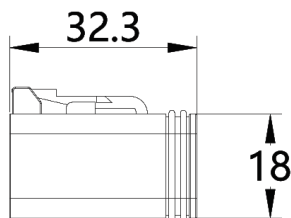
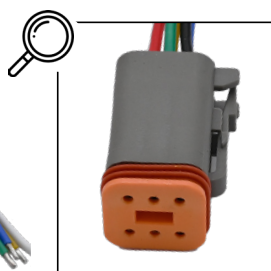
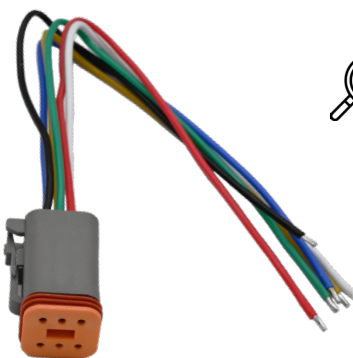

500743 | OE Ref: 57M7630 - CONNECTOR

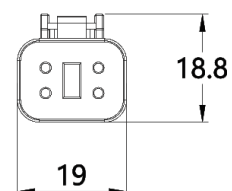
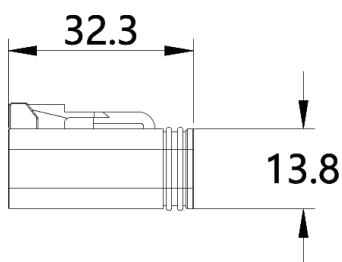
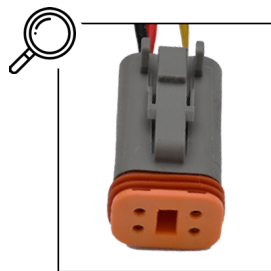
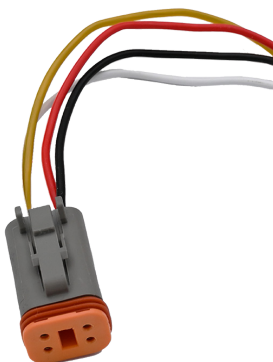

500744 | OE Ref: 57M8635 - CONNECTOR

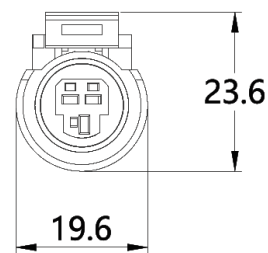
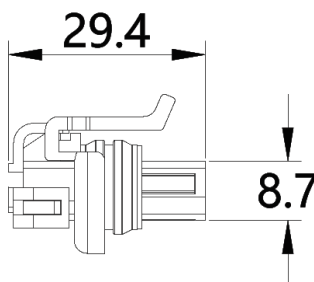
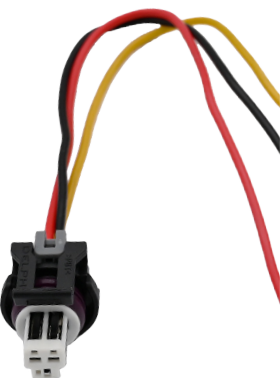

500745 | OE Ref: 57M8557 - CONNECTOR

# BEACONS



**BEACON 12/24V POLE MOUNTED**  
43628 | OE Ref: 82018390  
Ford New Holland / Case Series



**BEACON FLEXI 12V**  
53855 | OE Ref: ST0405



**BEACON FLEXI STEM 12V**  
59624 | OE Ref: EPM74596  
John Deere 6000 6010 6020 6030 Series



**BEACON 12V FLEXI STEM LUCAS TYPE**  
51321 | OE Ref: S19029



**LED BEACON 10-30V FLEXI STEM**  
56174



**BEACON 12V MAGNETIC C/W BULB LUCAS TYPE**  
51320



**BEACON 12-80V MINI XENON**  
51332



**BEACON LED MAGNETIC**  
56175



# BEACON BRACKETS



**BEACON BRACKET ASSEMBLY LH**

43190 | OE Ref: S14808

Ford New Holland 40 Series



**BEACON BRACKET RH**

43689



**BEACON BRACKET LH**

43688



**BEACON BRACKET ASSEMBLY RH**

43501 | OE Ref: S14808

Ford New Holland 40 Series



**BEACON BRACKET**

3687



**ADJUSTABLE BEACON BRACKET**

51034 | OE Ref: S.73137

John Deere 10 40 60 70 TM TS Series



**BEACON PLUG**

3680



**BEACON BRACKET**

3686

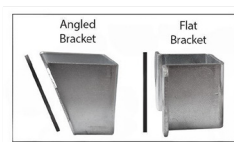

**BEACON BRACKET**

51388

OE Ref: 3778093M91

Spring Loaded  
Includes Flat and Angled Brackets



**BEACON BRACKET**

51387



**BEACON BRACKET**

51422



**BEACON BRACKET ADAPTOR**

51421



**BEACON BRACKET ADAPTOR**

53858



**BEACON BRACKET**

51417 | OE Ref: AL157850

John Deere 6J 6M 6R  
6020 6030 7030 Series

# LED WORK LAMPS

**NEW**

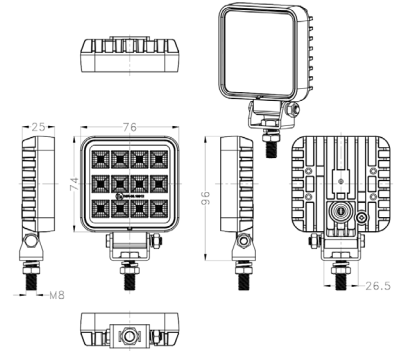
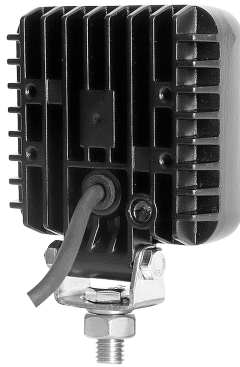

**100075 - LED WORKLIGHT - 3 INCH SQUARE 12W 900 LUMENS**

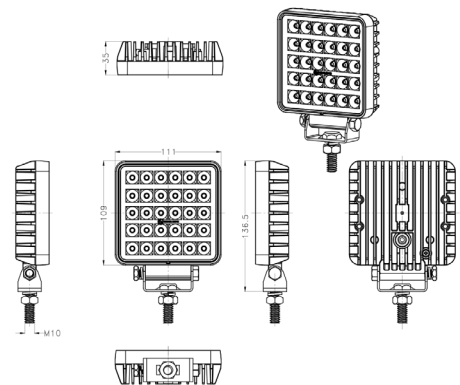

**100074 - LED WORKLIGHT - 4 INCH SQUARE 30W UTILITY HIGH INTENSITY 2,200 LUMENS**

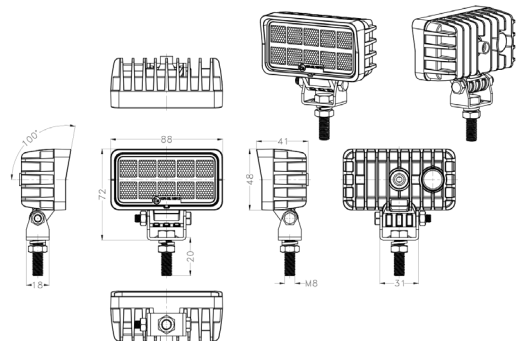

**100073 - LED WORKLIGHT - 3.5 INCH RECTANGLE 10W 850 LUMENS**

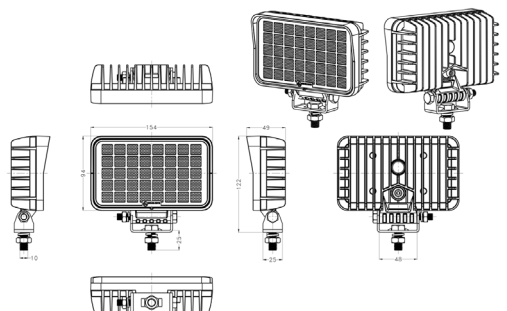

**100068 - LED WORKLIGHT - 3.5 INCH RECTANGLE 10W 850 LUMENS**



# LED WORK LAMPS

**NEW**

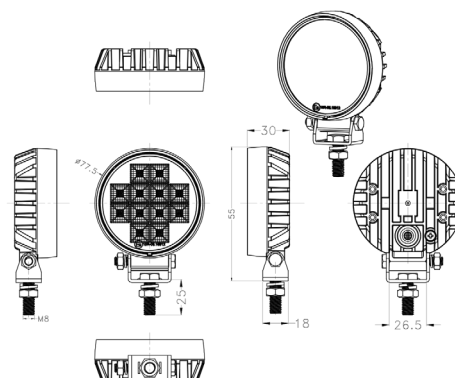
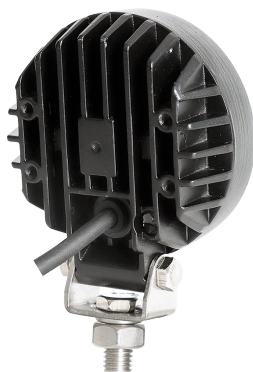

**100069 - LED WORKLIGHT - 3 INCH ROUND 12W 900 UTILITY HIGH INTENSITY LUMENS**

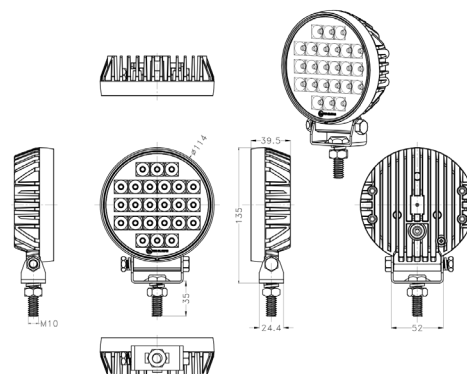

**100070 - LED WORKLIGHT - 4 INCH ROUND 24W UTILITY HIGH INTENSITY 1,800 LUMENS**

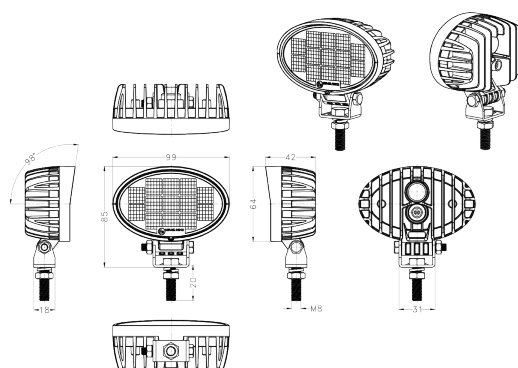

**100072 - LED WORKLIGHT - 4 INCH OVAL 13W OVAL 1,105 LUMENS**

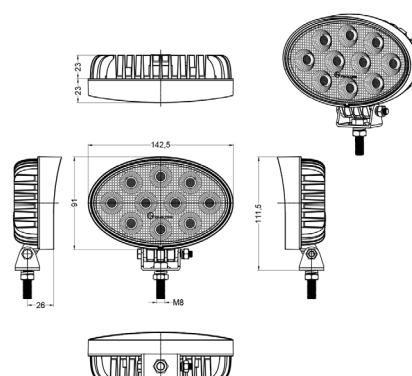

**100071 - LED WORKLIGHT - 6 INCH OVAL 40W 3,600 LUMENS**

# LINKAGE



**FRAME QUICK HITCH CAT 3**  
55803

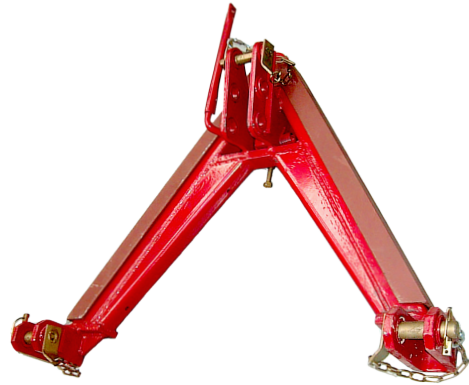

**REAR LINKAGE QUICK HITCH KIT CAT 2**  
51228K | OE Ref: S.23464

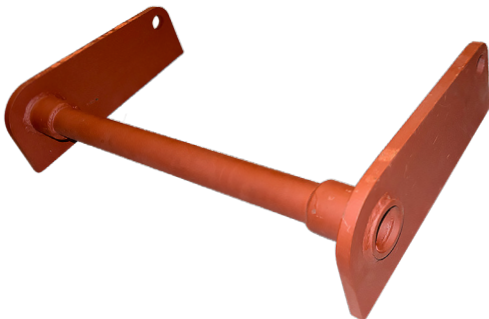

**LOADER BRACKET HEADSTOCK**  
55800



**LOADER BRACKET  
PIN & CONE HEADSTOCK**  
55797



**LINKAGE QUICK HITCH**  
51228 | OE Ref: S.23464



**SMART DRAWBAR ASSEMBLY CAT 1**  
55798  
Clevis & Ball Hitch



**SMART DRAWBAR  
ASSEMBLY CAT 2**  
55799  
Clevis & Ball Hitch



**DRAWBAR CAT 1 / 9 HOLE**  
180485 | OE Ref: 81826363  
Massey Ferguson 35 135 Series  
800mm Centre to Centre Size: 920mm



**DRAWBAR CAT 2 / 9 HOLE**  
3145 | OE Ref: 81811489  
MF 100 200 500 35 65 Series  
Ford 10 1000 30 40 600 700  
775mm Centre to Centre Size: 810mm

# LINKAGE

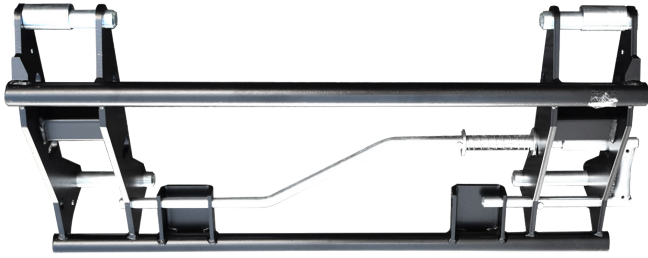

**QUICK ATTACH EURO BRACKET CARRIER FRAME**  
51852 | OE Ref: S110171



**QUICK ATTACH EURO BRACKET CARRIER FRAME HYDRAULIC LOCKING**  
55802

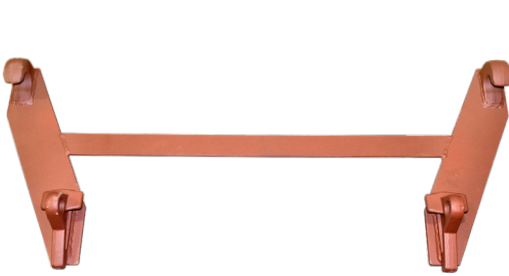

**QUICK ATTACH EURO BRACKET**  
51102 | OE Ref: S.23038

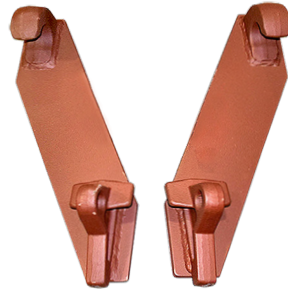

**PAIR QUICK ATTACH EURO BRACKET ARMS**  
52835 | OE Ref: S.23038



**LOADER BARCKET EYE**  
54567 | OE Ref: S.33091



**LOADER BARCKET HOOK**  
54568 | OE Ref: S.33090

## HEAVY DUTY TOP LINKS



**TOP LINK CAT 2**  
BB22380 | OE Ref: S16838  
2 Ball Ball 380mm Heavy Duty



**TOP LINK CAT 2**  
BH22380 | OE Ref: S19029  
2 Ball Hook 380mm Heavy Duty



**TOP LINK CAT 2**  
KB22380 | OE Ref: S99505  
2 Knuckle Ball 380mm Heavy Duty



**TOP LINK CAT 2**  
KH22380 | OE Ref: S19029  
2 Ball Hook 380mm Heavy Duty



# CONTROL & HYDRAULIC COMPONENTS



## JOYSTICK LEVER WITH BUTTON AND CABLE

**51144**

51966 – Lever ball

51278 – Button

51862 – Base



## SOLENOID

**3874**

Six Port 1/2" comes  
with Din Plug  
90 L/PM 65 WATT  
IP65 1/2 BSP

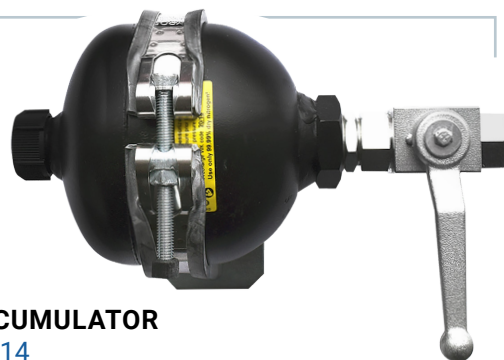

## ACCUMULATOR

**51714**

Front Loader  
Precharge 30 Bar Easy Ride

## ACCUMULATOR

**53313**

Front Loader  
Solenoid Control  
Precharge 30 Bar  
Easy Ride

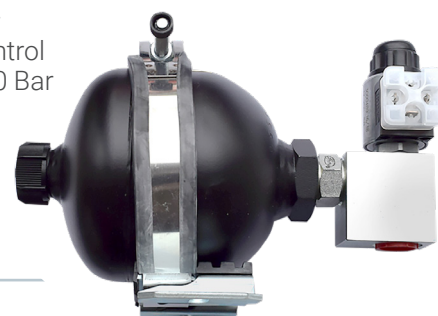

## QUICKE LOADER CABLES

Part No.	DESCRIPTION	SIZE
<b>53000</b>	BALL & EYE PIECE	1400MM
<b>53001</b>	BALL & EYE PIECE	1600MM
<b>53002</b>	BALL & EYE PIECE	1800MM
<b>53003</b>	BALL & EYE PIECE	2000MM
<b>53004</b>	BALL & EYE PIECE	2200MM
<b>53005</b>	BALL & EYE PIECE	2400MM
<b>53006</b>	BALL & EYE PIECE	2600MM
<b>53008</b>	BALL & EYE PIECE	3200MM
<b>53013</b>	BALL & EYE PIECE	1200MM
<b>53014</b>	BALL & EYE PIECE	3000MM
<b>55671</b>	BALL & ROD END	2000MM
<b>53009</b>	THREADED ENDS	1500MM
<b>53010</b>	THREADED ENDS	2000MM
<b>53011</b>	THREADED ENDS	1200MM
<b>53012</b>	THREADED ENDS	2400MM

## MORSE CABLE

Part No.	SIZE
<b>3732</b>	1500MM
<b>3731</b>	2000MM
<b>3736</b>	2500MM
<b>3762</b>	3000MM

## MORSE CABLE HOOK TYPE

Part No.	SIZE
<b>51872</b>	2000MM
<b>51873</b>	2500MM

## CABLE FITTING KITS

Part No.	DESCRIPTION & SIZE
<b>3720</b>	CABLE FITTING KIT - SPADE SPOOL - MALE
<b>3744</b>	CABLE FITTING KIT - FEMALE SPLINED
<b>51663</b>	FITTING KIT, CABLE AND HANDLE 1500MM
<b>51662</b>	FITTING KIT, CABLE AND HANDLE 2000MM